

# PURO INSET COUNTER-TOP WASHBASIN

(HEIGHT OF RIM 120 MM)

- elegant rectangular washbasin in a classically minimalist design
- reduced precise edges
- very generous interior dimensions
- clean and timeless lines – immortalised in long-lasting KALDEWEI steel enamel
- harmonises perfectly with the PURO bath series
- designed by Anke Salomon



Similar illustration

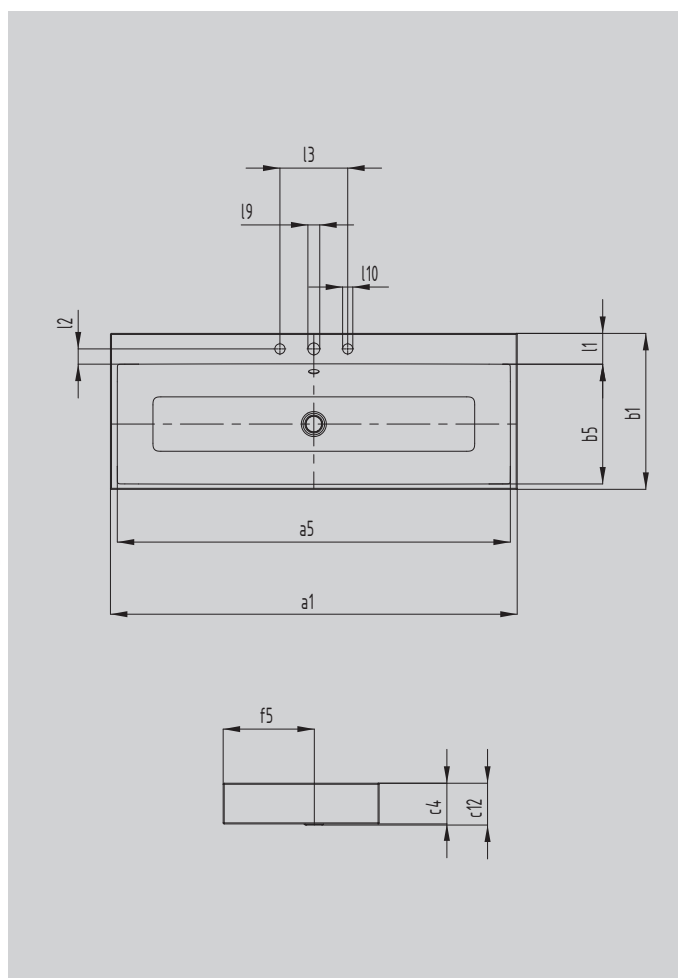

| Model   |                 | 3168    |
|---|-----------------|---------|
| External length                                     | a <sub>1</sub>  | 1200 mm |
| Internal length                                     | a <sub>5</sub>  | 1160 mm |
| External width                                      | b <sub>1</sub>  | 460 mm  |
| Internal width                                      | b <sub>5</sub>  | 354 mm  |
| Height of rim                                       | c <sub>4</sub>  | 120 mm  |
| Distance basin surface to bottom edge of waste hole | c <sub>12</sub> | 125 mm  |
| Distance rear edge to centre of waste hole          | f <sub>5</sub>  | 268 mm  |
| Depth of tap deck                                   | l <sub>1</sub>  | 91 mm   |
| Distance tap holes to edge                          | l <sub>2</sub>  | 45 mm   |
| Distance external tap holes (for 3 tap holes)       | l <sub>3</sub>  | 200 mm  |
| Diameter of centre tap hole                         | l <sub>9</sub>  | Ø 35 mm |
| Diameter of outside tap hole (for 3 tap holes only) | l <sub>10</sub> | Ø 30 mm |
| Net weight  |                 | 23 kg   |