

# PURO

## WALL-HUNG

## WASHBASIN

- elegant rectangular washbasin in a classically minimalist design
- reduced precise edges
- very generous interior dimensions
- clean and timeless lines – immortalised in long-lasting KALDEWEI steel enamel
- harmonises perfectly with the PURO bath series
- designed by Anke Salomon



Similar illustration

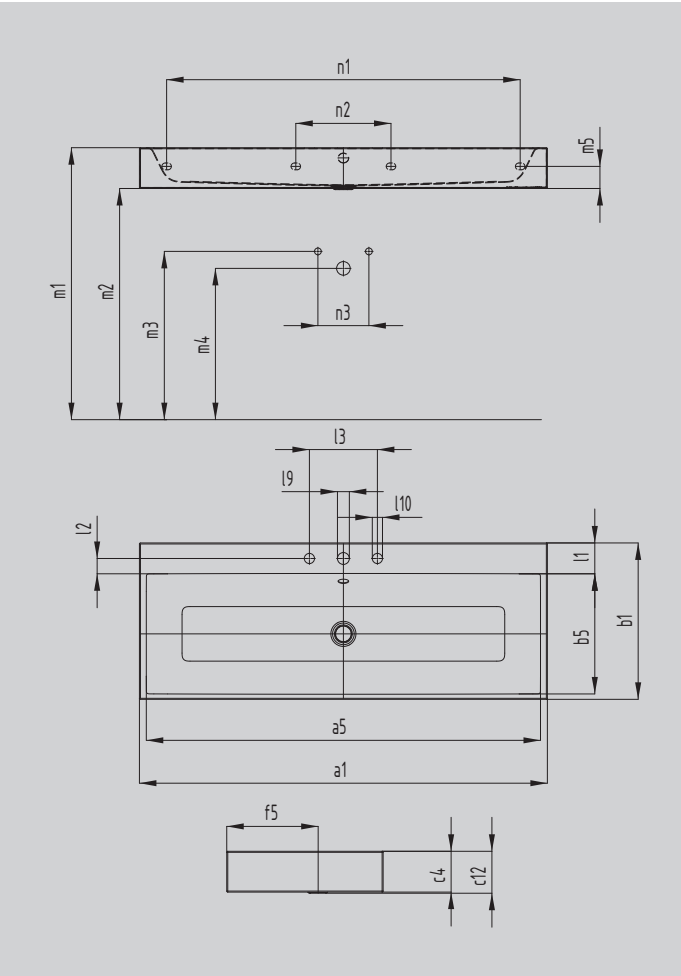

Model		3163
External length	a <sub>1</sub>	460 mm
Internal length	a <sub>5</sub>	420 mm
External width	b <sub>1</sub>	460 mm
Internal width	b <sub>5</sub>	345 mm
Height of rim	c <sub>4</sub>	120 mm
Distance basin surface to bottom edge of waste hole	c <sub>12</sub>	115 mm
Distance rear edge to centre of waste hole	f <sub>5</sub>	268 mm
Depth of tap deck	l <sub>1</sub>	91 mm
Distance tap holes to edge	l <sub>2</sub>	45 mm
Distance external tap holes (for 3 tap holes)	l <sub>3</sub>	200 mm
Diameter of centre tap hole	l <sub>9</sub>	Ø 35 mm
Diameter of outside tap hole (for 3 tap holes only)	l <sub>10</sub>	Ø 30 mm
Distance FF to top edge basin surface	m <sub>1</sub>	820 - 850 mm
Distance FF to bottom edge	m <sub>2</sub>	700 - 730 mm
Distance FF to centre of water inlet	m <sub>3</sub>	570 - 600 mm
Distance FF to centre of waste hole wall connection	m <sub>4</sub>	520 - 580 mm
Distance bottom edge to centre of fixing hole	m <sub>5</sub>	65 mm
Internal distance of fixing holes	n <sub>2</sub>	280 mm
Distance hot/cold water inlet	n <sub>3</sub>	80 - 150 mm
Net weight		11 kg