

MEISTERSTÜCK CLASSIC DUO OVAL

- freestanding bathtub with seamless enamelled panelling blends into a monolithic symphony made of KALDEWEI steel enamel
- archetypal design with oval contours and a stunning conical exterior appeals anywhere in the room. The distinctly narrow edge lends the bath a uniquely harmonious aesthetic
- two gently sloping backrests and the central waste and overflow fitting ensure relaxed bathing with a partner
- the Meisterstück is available with optional extras such as easy-clean finish for unrivalled hygiene and the KALDEWEI COMFORT LEVEL waste and overflow fitting

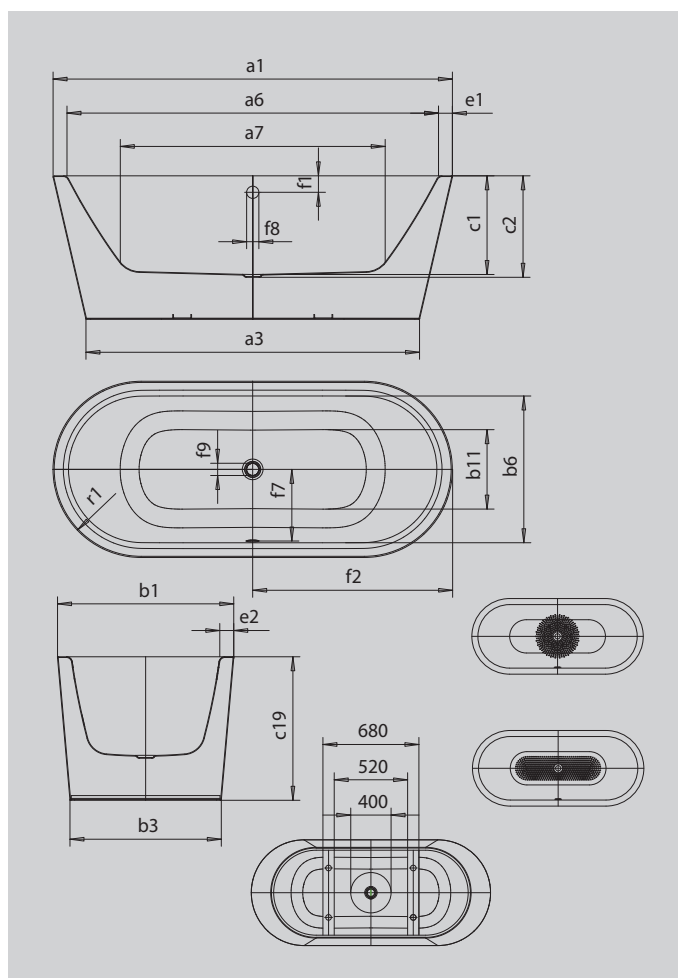

Similar illustration



| Model | | 1111 |
|--|------------|--------------|
| External length | a_1 | 1800 mm |
| External length (bottom) | a_3 | 1518 mm |
| Internal length (top) | a_6 | 1680 mm |
| Internal length (bottom) | a_7 | 1230 mm |
| External width | b_1 | 800 mm |
| External width (bottom) | b_3 | 693 mm |
| Internal width (top) | b_6 | 680 mm |
| Internal width (bottom) | b_{11} | 550 mm |
| Depth inside | c_1 | 420 mm |
| Depth incl. waste hole | c_2 | 430 mm |
| Height of bath | c_{19} | 610 mm |
| Width of rim (foot end; long side) | e_1, e_2 | 60; 60 mm |
| Distance top edge to centre of overflow hole | f_1 | 70 mm |
| Distance bath edge to centre of waste hole | f_2 | 900 mm |
| Distance centre of waste hole to centre of overflow hole | f_7 | 330 mm |
| Diameter of overflow hole | f_8 | Ø 52 mm |
| Diameter of waste hole | f_9 | Ø 52 mm |
| External radius | r_1 | 400 mm |
| Water volume | | 158 l |
| Net weight | | 139 kg |
| Diameter of anti-slip | | Ø 435 mm |
| Full anti-slip | | 900 x 300 mm |

KALDEWEI