

ESR FLOOR LEVEL
PLANNING ASSISTANCE

KALDEWEI

DETERMINING THE REQUIRED DIMENSIONS

A = mm Installed height

B = mm Flooring including adhesive

C = mm Wall covering including adhesive

INSTALLATION HEIGHT (A)

The built heights will vary, depending on the bottle trap design and shower surface model used. The following table will help you determine the built height of your product combination. If the built height is below the required minimum, you will need to create a floor recess or aperture. Also make sure to leave a safety margin between the bottle trap and floor.

SIPHON VERSIONS	CAYONOPLAN		CAYONOPLAN MULTISPACE	CONOFLAT	SCONA	SUPERPLAN							SUPERPLAN PLUS		SUPERPLAN ZERO
Shower tray depth	18 mm	25 mm	17 mm	23 mm	23 mm	25 mm	39 mm	40 mm	43 mm	47 mm	51 mm	25 mm	52 mm	20 mm	
KA 90 horizontal Mod. 4103	98 mm	105 mm	97 mm		103 mm	105 mm	119 mm	120 mm	123 mm	127 mm	131 mm				100 mm
KA 90 flat Mod. 4104	78 mm	85 mm	77 mm		83 mm	85 mm	99 mm	100 mm	103 mm	107 mm	111 mm				80 mm
KA 90 vertical Mod. 4105	49 mm	49 mm	49 mm		49 mm	49 mm	49 mm	49 mm	49 mm	49 mm	49 mm				49 mm
KA 120 horizontal Mod. 4106				106 mm								108 mm	135 mm		
KA 120 flat Mod. 4107				86 mm								88 mm	115 mm		
KA 120 vertical Mod. 4108				49 mm								49 mm	49 mm		

Overview of installation heights of shower tray and siphon

As well as an exceptionally flat, non-adjustable installation height of 49 mm, the ESR floor-level enables adjustable built heights of 63 mm to 164 mm. In addition, a separate extension kit can be added to the system with ease for special built heights of 164 mm to 250 mm. Our system is supplied with recess aids for the screed recess. Screed recesses for built heights of over 164 mm need to be created on site.

ESR FLOOR LEVEL

S
A=49mm

I
A=63-77mm

II
A=75-99mm

III
A=97-131mm

III+V
A=131-164mm

OPTIONAL ADJUSTMENT UNIT
A=164-190mm

A=190-250mm

Overview of adjustable installation heights of the ESR floor level

FLOOR COVERING (B)

The ESR floor-level is designed for flooring (consisting of floor tile, tile adhesive and composite sealing) up to 16 mm thick. For thicker flooring, you will need to clear the tile as illustrated.

DETERMINING THE REQUIRED FLOOR RECESS BASED ON THE WALL COVERING USED

The ESR floor-level is designed for a wall covering (consisting of wall tile, tile adhesive and composite sealing) up to 10 mm thick. Bear in mind that the ESR floor-level is 28 mm wider and longer than the shower surface (e.g. shower surface size: 90 x 90 cm, screed cutout required for installation of shower surface with ESR floor-level: 92.8 x 92.8 cm).

For a thicker wall covering, make sure to use load-bearing lining for the marked gap (D).

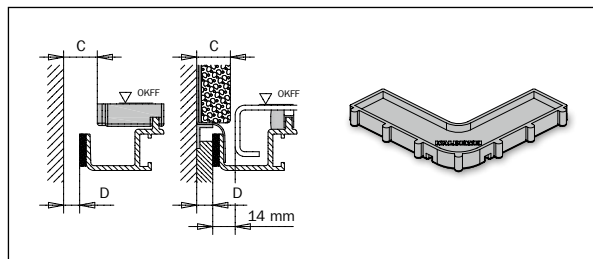

First step: Determine the required gap size (D) between the wall and ESR floor level (for installation situations 2, 3 and 4).

$$C \text{ [mm]} - 10 \text{ mm} = D \text{ [mm]}$$

Second step: Determine the respective recesses (a_1 and b_1) taking into account the installation situation.

INSTALLATION SITUATION 1:

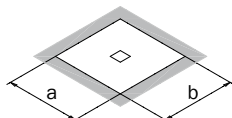

$$a \text{ [mm]} + 28 \text{ mm} = a_1 \text{ [mm]}$$

$$b \text{ [mm]} + 28 \text{ mm} = b_1 \text{ [mm]}$$

INSTALLATION SITUATION 2:

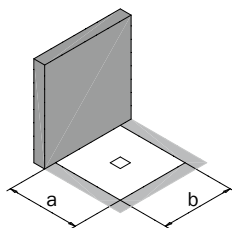

$$a \text{ [mm]} + 28 \text{ mm} + D \text{ [mm]} = a_1 \text{ [mm]}$$

$$b \text{ [mm]} + 28 \text{ mm} = b_1 \text{ [mm]}$$

INSTALLATION SITUATION 3:

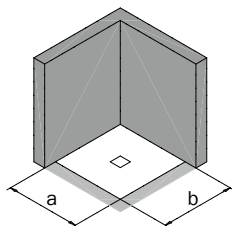

$$a \text{ [mm]} + 28 \text{ mm} + D \text{ [mm]} = a_1 \text{ [mm]}$$

$$b \text{ [mm]} + 28 \text{ mm} + D \text{ [mm]} = b_1 \text{ [mm]}$$

INSTALLATION SITUATION 4:

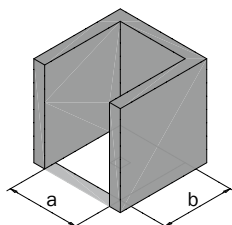

$$a \text{ [mm]} + 28 \text{ mm} + D \text{ [mm]} + D \text{ [mm]} = a_1 \text{ [mm]}$$

$$b \text{ [mm]} + 28 \text{ mm} + D \text{ [mm]} = b_1 \text{ [mm]}$$

a = length of the shower tray
b = width of the shower tray

a_1 = length of screed recess to be taken into account
 b_1 = width of screed recess to be taken into account

C = tile including tile adhesive
D = gap size between ESR II and wall connection



Please note: This planning principle does not replace the installation instructions included in the delivery and which are also available on our website at www.kaldewei.com.

Subject to technical alterations, tolerances and errors.

Franz Kaldewei GmbH & Co. KG
Beckumer Straße 33-35
59229 Ahlen
Tel. +49 2382 785 0
Fax +49 2382 785 200
www.kaldewei.com